

Lithium Iron Phosphate (LiFePO4) Battery

LFP12.8V110AH

Features Of LiFePO4 Battery

Longer Cycle Life: Offers up to 20 times longer cycle life and five times longer float/calendar life than lead acid battery, helping to minimize replacement cost and reduce total cost of ownership.

Lighter Weight: About 40% of the weight of a comparable lead acid battery. A 'drop in' replacement for lead acid batteries.

Higher Power: Delivers twice power of lead acid battery, even high discharge rate, while maintaining high energy capacity.

Wider Temperature Range: -20 C~60 C.

Superior Safety: Lithium Iron Phosphate chemistry eliminates the risk of explosion or combustion due to high impact, overcharging or short circuit situation.



Physical Dimension-mm

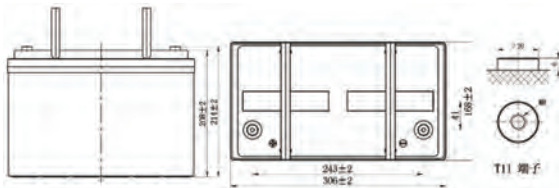

Typical Applications

- Wheelchairs and scooters
- Solar/wind energy storage
- Back-up power for small UPS
- Golf trolleys & buggies
- Electric bikes
- Tools

Specification

Electrical Characteristics	Nominal Voltage	12.8V
	Nominal Capacity	110Ah
	Energy	1408Wh
	Internal Resistance(AC)	≤50m Ω
	Cycle Life	>2000 cycles@ 0.5C 100%DOD
	Months Self Discharge	<3%
	Efficiency of Charge	100%@ 0.5C
	Efficiency of Discharge	96~99% @0.5C
Standard Charge	Charge Voltage	14.6±0.2V
	Charge Mode	0.2C to 14.6V, then 14.6V,charge current to 0.02C (CC/CV)
	Charge Current	55A
	Max. Charge Current	110A
	Charge Cut-off Voltage	14.6V±0.2V
Standard Discharge	Rated Discharge Current	55A
	Max. Discharge Current	110A
	Maximum pulse discharge current	150A (30S)
	Discharge Cut-off Voltage	10V
Environmental	Charge Temperature	0 °C to 55 °C (32F to 131F) @60±25% Relative Humidity
	Discharge Temperature	-20 °C to 60 °C (-4F to 140F) @60±25% Relative Humidity
	Storage Temperature	-20 °C to 45 °C (-4F to 113F) @60±25% Relative Humidity
	IP Class	IP67
Mechanical	Plastic Case	ABS
	Approx. Dimensions	306mm*168mm*214mm (12.04in.*6.61in.*8.42in.)
	Approx. Weight	11.8kg (26.05 lbs)
	Terminal	M8

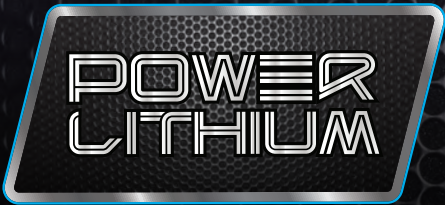

LifePO4 LITHIUM ION

Lithium Iron Phosphate (LiFePO4) Battery LFP12.8V110AH

Different Rate Discharge Curve(25°C)

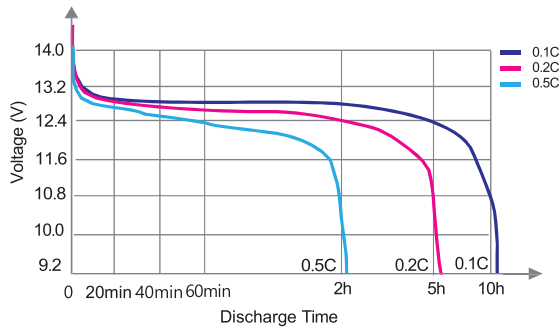

Different Temperature Discharge Curve(0.5C)

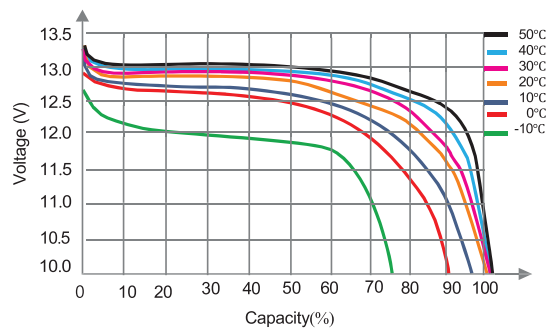

State of Charge Curve(0.5C, 25°C)

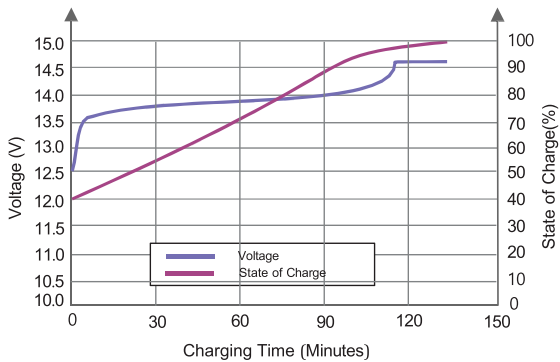

Charging Characteristics(0.5C, 25°C)

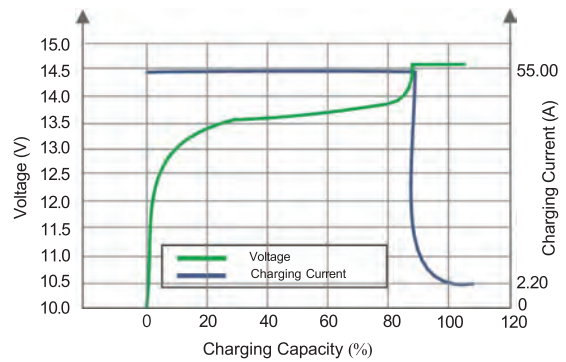

Different DOD Discharge Cycle Life Curve(0.5C)

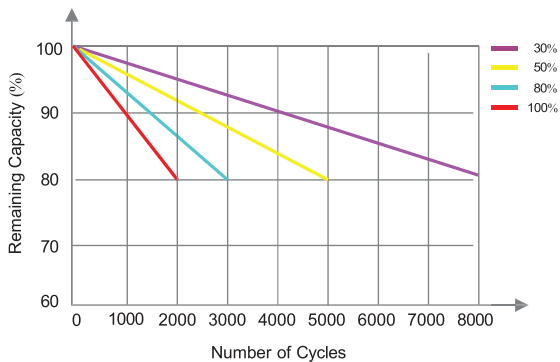

Different Temperature Self Discharge Curve

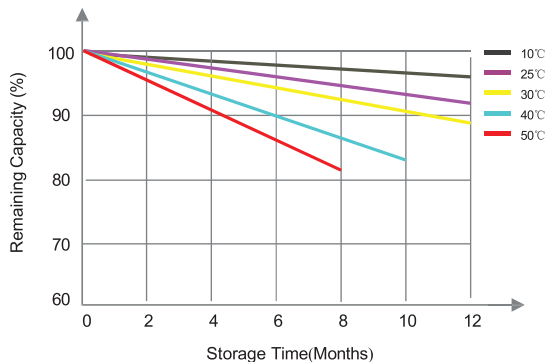

UN 38.3



IEC 62619



IEC62133-2



POWERCELL TECHNOLOGY



ISO 9001



ISO14001



ISO14001