

NPC-iSS44H CCA650 55AH RC100

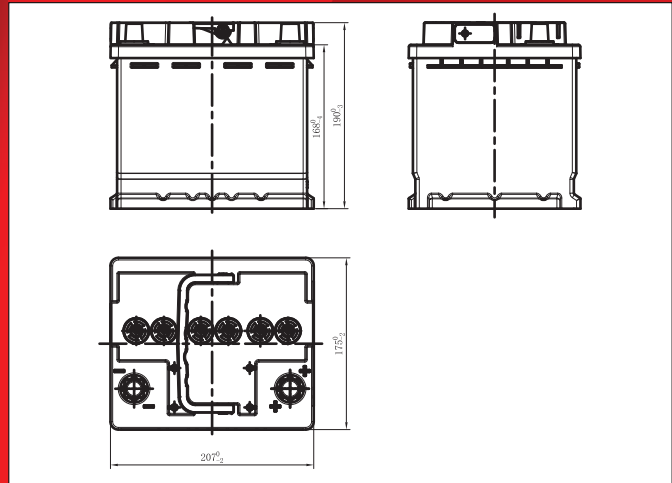

Dimensions (mm)



Physical Specification (mm)

Nominal Voltage		12V
Nominal Capacity(20HR)		55Ah
Dimension	Length	207+0/-2mm(8.15inches)
	Width	175+0/-2mm(6.89inches)
	Container Height	190+0/-3mm(7.48inches)
	Total Height(with Terminal)	190+0/-3mm(7.48inches)
Weight		Approx 15.1kg (33.3lbs)
Standard Terminal		1
Cell layout		0
Hold-Down		B13
Cell plate qty		/
Case		Black-PP Material
Cover		Black-PP Material
Handle		Black-PP Material

Electrical Specification

Rated Capacity	20 hour rate(2.5A)	55Ah
Reserve Capacity		100
Cold Cranking Performance Amps@0°F(-18°C)		650

Standard Terminal (mm)

Terminal Type	D	
	Positive	Negative
1	19.5 ⁰ _{-0.3}	17.9 ⁰ _{-0.3}

Cell Layout

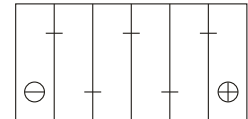

Figure(0)

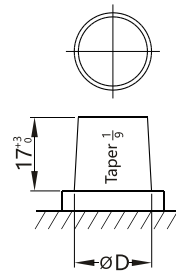

Discharge Characteristics(-18°C,0°F)

AGM-L1(CCA-SAE)

(CCA-SAE)Capacity Test(@-18)with I= 650

Spec U_{10s} ≥ 7.5V U_{30s} ≥ 7.2V

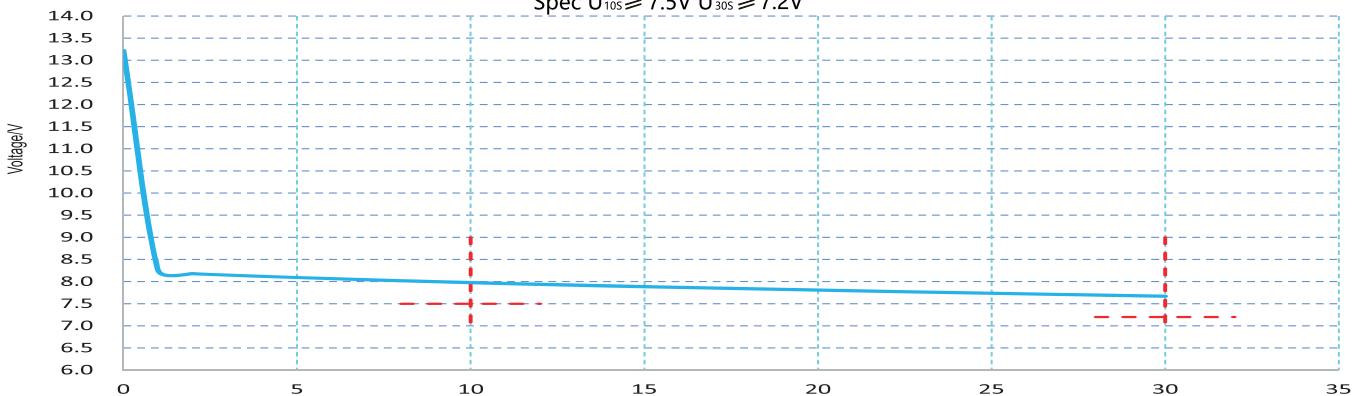

*Values are subject to variation of +/- 5% in normal manufacturing processes.
*Technical specifications and the product line above could be changed without prior notice.